

1 Verify Kit Contents

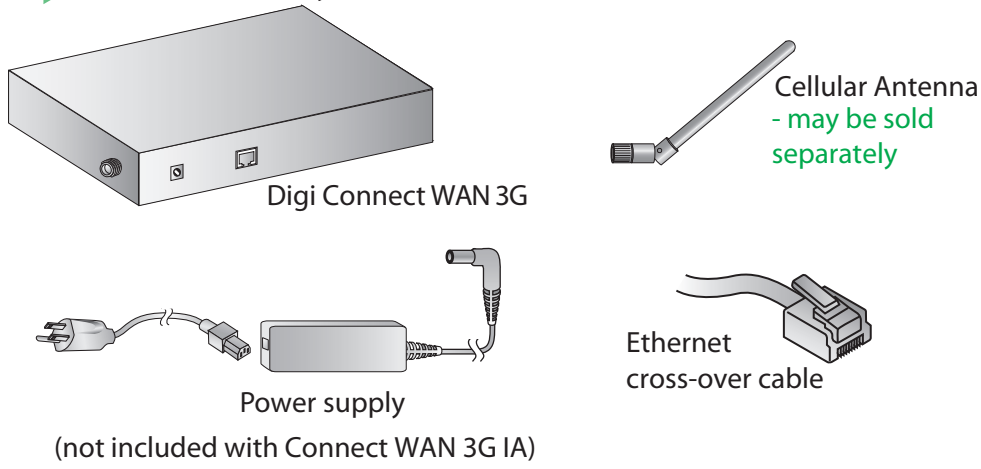

Not Included: A SIM card must be supplied and activated by a Cellular Service Provider for device operation.



Quick Start Guide

Digi Connect® WAN 3G
 Digi Connect® WAN 3G IA
 GSM, EDGE, HSDPA, HSUPA, or UMTS provisioning

90000868_E

2 Insert SIM Card(s)

- a** Remove the SIM slot cover plate and insert SIM card(s) as shown.
- b** Re-attach the SIM slot cover plate when finished.

NOTE: The primary SIM Card should be installed in the upper SIM slot, and the contacts should be face down. In the lower slot, the contacts should be face up. In both cases, the end of the SIM card with the chamfered corner should be inserted first.

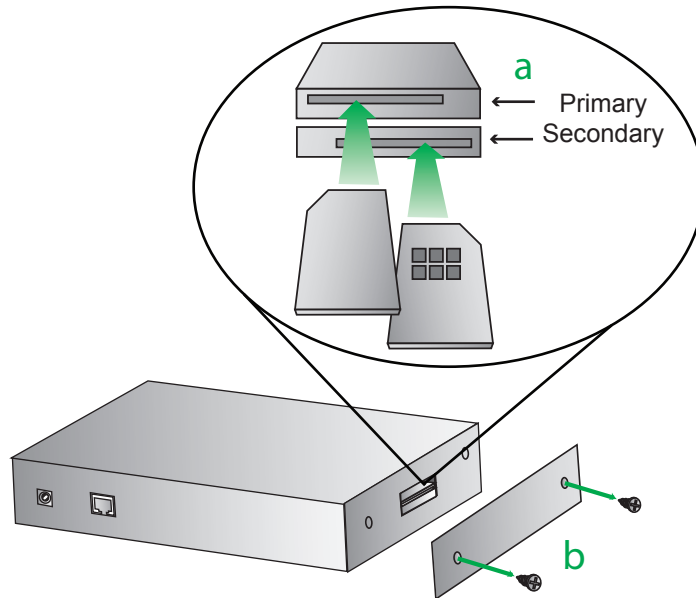

3 Connect Hardware

- a** Connect the cellular antenna
- b** Connect the Ethernet cross-over cable to a PC and the Ethernet port located directly next to the power jack
- c** Connect the power supply

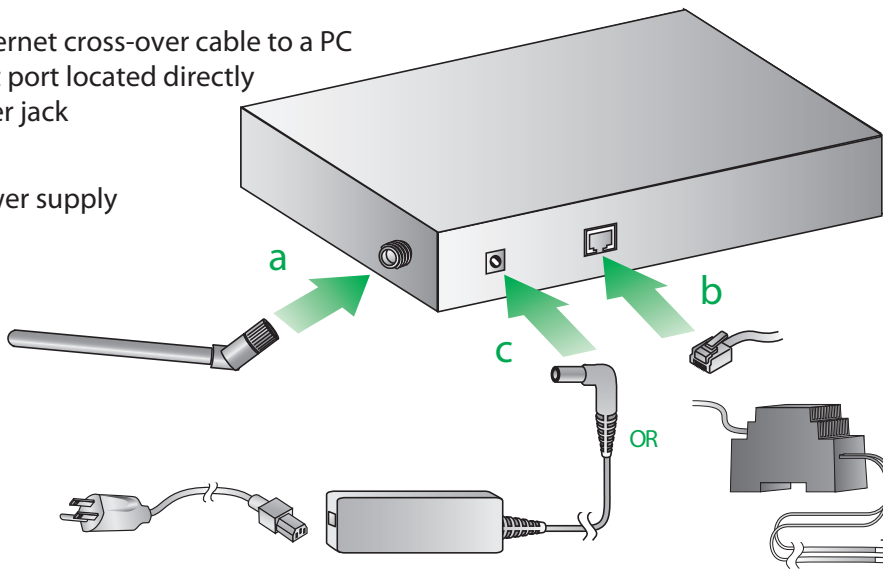

External power supply for Connect WAN 3G IA models (not included)

DB9 Serial Pinout

DB9	RS232	RS422/485 Full Duplex	RS485 Half Duplex
1	DCD	CTS-	not used
2	RxD	RxD+	RxD+
3	TxD	TxD+	TxD+
4	DTR	DTR	not used
5	GND	GND	GND
6	DSR	RxD-	RxD-
7	RTS	RTS+	not used
8	CTS	CTS+	not used
9	RI	TxD-	TxD-

NOTE: Set serial mode in software then on the web interface go to Configuration/Serial Ports.

4 Configure your Cellular Settings

- a** Open your web browser and enter the IP address 192.168.1.1 in the URL address bar.
- b** Under Configuration, click "Mobile." Enter your service provider name and connection parameters and click "Apply". Your device is now configured. If you would like to verify your connections go to step 5.

NOTE: If you have difficulty discovering your device, make sure your host computer is set up to obtain IP addresses automatically (DHCP server is enabled by default on the device). Also, ensure all firewall software is temporarily disabled.

5 Validate Internet Connection

- a** Disconnect the Ethernet cross-over cable and reconnect it. This will re-establish the Ethernet connection by assigning a new IP address through the DHCP server.
- b** To verify your Internet connection, enter a website of your choice (e.g. www.digi.com) in the URL address bar of your browser and click "enter." Connecting to a website indicated the connection is working.

For additional information about your cellular connection, click System Information > Mobile or reference the User's Guide provided on the Digi support site (www.digi.com/support/).